

# LOVECB OUTREACH

## PRAYER OVER CITY INITIATIVE:

1. Please choose an area to prayer walk/drive. Circle the area you want to pray over and turn it in at the door when you leave.
2. You may take this back to your church to get others involved. We ask that you pray over your area at least monthly and more often if possible.

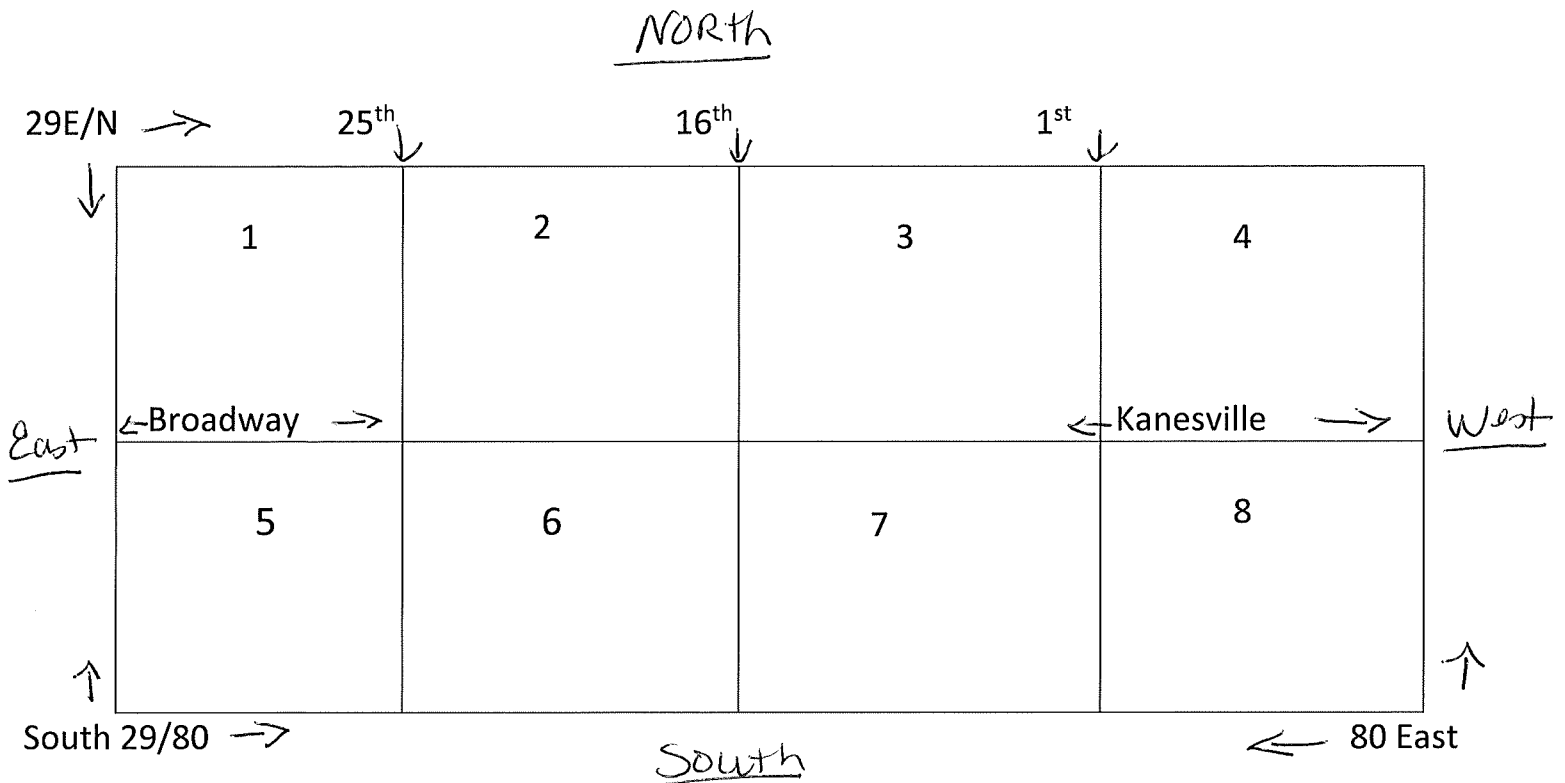

9. Areas Surrounding Council Bluffs just outside interstate

10. High crime areas

## You can also choose a specific topic to pray over:

### 7 Pillars of influence:

1. Government
2. Media
3. Education/schools
4. Family
5. Churches
6. Arts/entertainments-casinos
7. Business

WE WOULD LIKE TO KNOW WHAT OUTREACHES YOUR CHURCHES HAS AVAILABLE. IF YOU ARE AWARE, PLEASE WRITE ON BACK OF THIS SHEET.

# **LOVECB OUTREACH**

## 1. **Worship/prayer night late Jan-Early Feb**

- a. Where? Recommend a neutral place
- b. When? Recommend Sunday night at 6pm
- c. Who? Recommend various worship team members from area churches to create a true united worship team.  
Teri has offered HHP for practice and the worship night if needed.
- d. Post on social media, have announced, posted on KGBI page?

## 2. **Meeting format:**

- a. Start with Warring worship
- b. Make New years declarations for the year.
- c. Divide into groups to pray over the areas of influence and give out handouts for prayer sign up.
- d. Casting vision-encourage sign up for prayer areas

## 3. **Goals for Feb to May:**

- a. Set up for worship in the park starting 1<sup>st</sup> Thursday in May-National day of prayer
- b. Mail all area churches and invite to participate and follow up with a phone call 1 month later.
- c. Develop worship team/teams from area churches for the worship nights in the park.
- d. Have social media up and running posting events.

## 4. **Future goals:**

- a. Have every 3 to 4 month worship prayer events hosted by different churches
- b. Post local churches outreach events on social media.
- c. Post a focus on a local church weekly on social media.
- d. Have someone develop an app similar to what is done in Portland to map prayer walking, local outreach events.